

AGENDA
SHAKOPEE PUBLIC UTILITIES COMMISSION
REGULAR MEETING
July17, 2017

1. **Call to Order** at 5:00pm in the SPUC Service Center, 255 Sarazin Street.
2. **Approval of Minutes**
3. **Communications**
4. **Approve the Agenda**
5. **Approval of Consent Business**
6. **Bills: Approve Warrant List**
 - 6a) July 3, 2017
 - 6b) July 17, 2017
7. **Liaison Report**
8. **Reports: Water Items**
 - 8a) Water System Operations Report – Verbal
 - 8b) Haven Ridge – Prior Lake Temporary Water
 - C=> 8c) Quarterly Nitrate Results
 - C=> 8d) Water Production Dashboard
9. **Reports: Electric Items**
 - 9a) Electric System Operations Report – Verbal
 - 9b) June 2017 MMPA Board Meeting Public Summary
 - 9c) WMP Partners – Smart Grid Business Case Review
10. **Reports: Human Resources**
11. **Reports: General**
 - 11a) Daffron iXP Upgrade Project Update - Verbal
 - 11b) June 2017 Financial Results
12. **New Business**
13. **Tentative Dates for Upcoming Meetings**

- Regular Meeting	--	August 7
- Mid Month Meeting	--	August 21 (MMPA Conference)
- Regular Meeting	--	September 5 (Tuesday)
- Mid Month Meeting	--	September 18
14. **Adjourn to 8/7/17** at the SPUC Service Center, 255 Sarazin Street

MINUTES
OF THE
SHAKOPEE PUBLIC UTILITIES COMMISSION
(Regular Meeting)

Vice President Weyer called the regular session of the Shakopee Public Utilities Commission to order at the Shakopee Public Utilities meeting room at 5:00 P.M., June 19, 2017.

MEMBERS PRESENT: Commissioners Joos, Helkamp, Hennen and Weyer. Also present, Finance Director Schmid, Planning & Engineering Director Adams, Line Superintendent Drent, Water Superintendent Schemel and Marketing/Customer Relations Director Walsh. Commissioner Amundson was absent as previously advised.

Motion by Helkamp, seconded by Joos to approve the minutes of the June 5, 2017 Commission meeting. Motion carried.

There were no Communications to report.

Vice President Weyer offered the agenda for approval.

Motion by Helkamp, seconded by Hennen to approve the agenda as presented. Motion carried.

Motion by Joos, seconded by Helkamp to approve the Consent Business agenda as presented. Motion carried.

Vice President Weyer stated that the Consent Items were: Item 8c: Water Production Dashboard and Item 11c: May 2017 Financial Results.

The warrant listing for bills paid June 19, 2017 was presented.

Motion by Joos, seconded by Hennen to approve the warrant listing dated June 19, 2017 as presented. Motion carried.

Water Superintendent Schemel provided a report of current water operations. Water service leaks on street reconstruction projects were discussed. Other construction projects were updated.

Motion by Joos, seconded by Helkamp to offer Resolution #1165. A Resolution Setting The Amount Of The Trunk Water Charge, Approving Its Collection And Authorizing Water Service To Certain Property Described As: West Vierling Acres Second Addition. Ayes: Commissioners Hennen, Joos, Helkamp and Weyer. Nay: none. Motion carried. Resolution passed.

Item 8c: Water Production Dashboard was received under Consent Business.

Line Superintendent Drent provided a report of current electric operations. Eight electric outages were reviewed. The cause of each outage was discussed. SCADA training will continue and the SCADA project is on schedule. Several construction updates were provided.

The West Monroe Partners "Smart Grid Business Case and Technology Roadmap for SPU" Report was received by the Commission for review. Discussion regarding the report will take place at a future meeting.

Finance Director Schmid reviewed the 2016 Total Compensation and Benefits Summaries that were provided to all SPU employees.

Marketing/Customer Relations Director Walsh updated the Commission on the status of the Daffron iXP Upgrade Project. The complicated project is still on schedule to "go live" in mid August.

Vice President Weyer presented the Utilities Manager's Goals and Objectives for 2017.

Item 11c: May 2017 Financial Results was received under Consent Business.

The tentative commission meeting date of July 3 was canceled and July 17 will be scheduled as the next Commission meeting.

Motion by Helkamp, seconded by Joos to adjourn to the July 17, 2017 meeting. Motion carried.

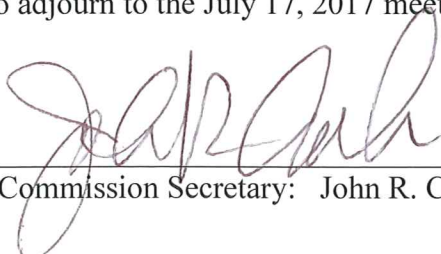

Commission Secretary: John R. Crooks

**SHAKOPEE PUBLIC UTILITIES
MEMORANDUM**

TO: SHAKOPEE PUBLIC UTILITIES COMMISSION
FROM: JOHN R. CROOKS, UTILITIES MANAGER
SUBJECT: HAVEN RIDGE TEMPORARY WATER REQUEST
DATE: JULY 13, 2017

Attached to this memo is a request from M/I Homes of Minneapolis requesting Shakopee's municipal water system provide temporary water, as described, to their residential housing development in Prior Lake.

SPU Staff has determined the water system would be able to accommodate this request. Discussions have taken place with the developer, City of Prior Lake Staff as well as SPU Staff. Discussions have also taken place with our water consultant, John Karwacki of Sambatek Engineering regarding the request.

Further discussions may lead to a permanent interconnection with the Prior Lake water system. Presently, SPU has 2 interconnections with the City of Savage. The MN DNR looks favorably with municipal water supply interconnections. This may be important due to the residential growth in Shakopee and the future need to increase our water appropriations with the DNR.

Recommendation –

To have SPU Staff continue in the negotiations in providing the temporary water supply to the 25 residential homes as part of the Villa home portion of Phase 1 of the Ridge Haven development in Prior Lake.



Minneapolis Division
941 Hillwind Rd NE, Suite 300
Fridley, MN 55432
763.586.7200 OFFICE
763.572.9417 FAX

7/12/17

Re: Request for temporary water connection

Dear Mr. John Crooks and the Shakopee Public Utilities Commission,

We as MI Homes of Minneapolis, LLC are formally requesting a water connection from the City of Shakopee to temporarily serve a portion of the Haven Ridge residential development in Prior Lake. Please see attached exhibits for reference. Haven Ridge is an approved preliminary plat of 133 single family home sites to be built in two phases. Our main entrance to the community and model home center will be located on CR18 at the Northwest corner of the site on the Shakopee border. Once installed our planned permanent water source will come from the booster station at Summit Preserve, and the existing Kensington Ave stub. Due to the timing of our final approvals, progress at Summit Preserve, and amount of site work to connect, we will not be able to complete the necessary improvements by freeze up. We are requesting a temporary connection be made at the intersection of CR18 and Whispering Oaks Trail to serve 25 residential homes noted on exhibit A as part of the Villa home portion of phase one. This connection will give us the ability to market and complete home sites in 2017, and final connections will be made in 2018. We are requesting this connection be made approximately the week of September 4th 2017, and remain active for one year from the connection date.

We thank you for the consideration of our request. Please feel free to contact me with any questions.

Sincerely,

Jason Biederwolf
Director of Land Development
MI Homes of Minneapolis

VILLA SETBACK TABLE

Structure Setback Requirements (NA denotes not applicable)	Front	Rear	Side	Notes	Comments
Living space foundation to ROW	20	20	4	NA	
Garage foundation to ROW	20	20	4	NA	
Living space foundation to curb	NA	NA	NA	-	
Garage foundation to curb	NA	NA	NA	-	
Living space foundation to parking bay	NA	NA	NA	NA	
Garage foundation to parking bay	NA	NA	NA	NA	
Living space foundation to property line	20	20	4	NA	
Garage foundation to property line	20	20	4	NA	
Corner yard to ROW	20	20	20	-	
Pool boundary	20	20	20	-	
Wetland Buffer structure setback	20	20	20	-	
Wetland Buffer grading setback	10	10	10	-	
Pond HIL structure setback	30	30	30	-	
Pond HIL grading setback	NA	NA	NA	NA	
Lake HIL structure setback	50	50	50	-	
Lake HIL grading setback	NA	NA	NA	NA	
Buff structure setback	NA	NA	NA	NA	
Right-of-way County Road 18	30	30	30	-	
Easement e.g. pipeline, transmission line	30	30	30	-	

Building features allowed in setbacks: (Y indicates feature is allowed in setbacks) (N indicates feature is not allowed in setbacks)	Front	Rear	Side	Notes	Comments
Covered stoop / porch	NO	NO	NO	-	
Uncovered stoop / porch	NO	NO	NO	-	
Canter (area limit if applicable =)	YES	YES	YES	YES	18" MAX.
Fireplace	YES	YES	YES	YES	18" MAX.
Deck	NO	NO	NO	-	
3 or 4 Season Porch	NO	NO	NO	-	
Patio	NO	NO	NO	-	
Eaves	YES	YES	YES	YES	18" MAX.
Grass pit	NO	NO	NO	-	
Other: air conditioner	YES	YES	YES	YES	

Building features allowed in easements: (Y indicates feature is allowed in setbacks) (N indicates feature is not allowed in setbacks)	Front	Rear	Side	Notes	Comments
Eaves	YES	YES	YES	-	18" MAX.
Grass pit	NO	NO	NO	-	
Driveway	YES	YES	YES	-	

SINGLE FAMILY SETBACK TABLE

Structure Setback Requirements (NA denotes not applicable)	Front	Rear	Side	Notes	Comments
Living space foundation to ROW	20	20	7.5	NA	
Garage foundation to ROW	20	20	7.5	NA	
Living space foundation to curb	NA	NA	NA	-	
Garage foundation to curb	NA	NA	NA	-	
Living space foundation to parking bay	NA	NA	NA	NA	
Garage foundation to parking bay	NA	NA	NA	NA	
Living space foundation to property line	20	20	7.5	NA	
Garage foundation to property line	20	20	7.5	NA	
Corner yard to ROW	20	20	20	-	
Pool boundary	20	20	20	-	
Wetland Buffer structure setback	20	20	20	-	
Wetland Buffer grading setback	10	10	10	-	
Pond HIL structure setback	30	30	30	-	
Pond HIL grading setback	NA	NA	NA	NA	
Lake HIL structure setback	50	50	50	-	
Lake HIL grading setback	NA	NA	NA	NA	
Buff structure setback	NA	NA	NA	NA	
Right-of-way non Lighter	NA	NA	NA	NA	
Easement e.g. pipeline, transmission line	NA	NA	NA	NA	

Building features allowed in setbacks: (Y indicates feature is allowed in setbacks) (N indicates feature is not allowed in setbacks)	Front	Rear	Side	Notes	Comments
Covered stoop / porch	NO	NO	NO	-	
Uncovered stoop / porch	NO	NO	NO	-	
Canter (area limit if applicable =)	YES	YES	YES	YES	18" MAX.
Fireplace	YES	YES	YES	YES	18" MAX.
Deck	NO	NO	NO	-	
3 or 4 Season Porch	NO	NO	NO	-	
Patio	NO	NO	NO	-	
Eaves	YES	YES	YES	YES	18" MAX.
Grass pit	NO	NO	NO	-	
Other: air conditioner	YES	YES	YES	YES	

Building features allowed in easements: (Y indicates feature is allowed in setbacks) (N indicates feature is not allowed in setbacks)	Front	Rear	Side	Notes	Comments
Eaves	YES	YES	YES	-	18" MAX.
Grass pit	NO	NO	NO	-	
Driveway	YES	YES	YES	-	

CURVE TABLE

CDPT	BLN	LNCH	LNCH	LNCH	PC	P2
0	117327	45.00	20.00	24.00	117327	117327
1	117327	117.00	117.00	117.00	117327	117327
2	117327	117.00	117.00	117.00	117327	117327
3	117327	117.00	117.00	117.00	117327	117327
4	117327	117.00	117.00	117.00	117327	117327
5	117327	117.00	117.00	117.00	117327	117327
6	117327	117.00	117.00	117.00	117327	117327
7	117327	117.00	117.00	117.00	117327	117327
8	117327	117.00	117.00	117.00	117327	117327
9	117327	117.00	117.00	117.00	117327	117327
10	117327	117.00	117.00	117.00	117327	117327
11	117327	117.00	117.00	117.00	117327	117327
12	117327	117.00	117.00	117.00	117327	117327
13	117327	117.00	117.00	117.00	117327	117327
14	117327	117.00	117.00	117.00	117327	117327
15	117327	117.00	117.00	117.00	117327	117327

DENSITY SUMMARY

CITY OUTLOT SUMMARY	Area
OUTLOT A	3.52 AC
OUTLOT D	6.61 AC
OUTLOT E	3.11 AC
OUTLOT F	0.58 AC
NET AREA	13.82 AC

AREA SUMMARY	Area
GROSS AREA	55.35 AC
COUNTY ROW	0.86 AC
PARK	2.02 AC
CITY OUTLOTS	13.82 AC
NET AREA	38.55 AC

133 LOTS / 38.55 AC = 3.45 LOTS/AC

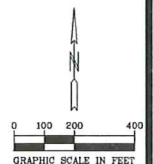
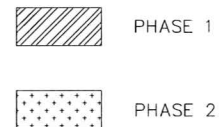
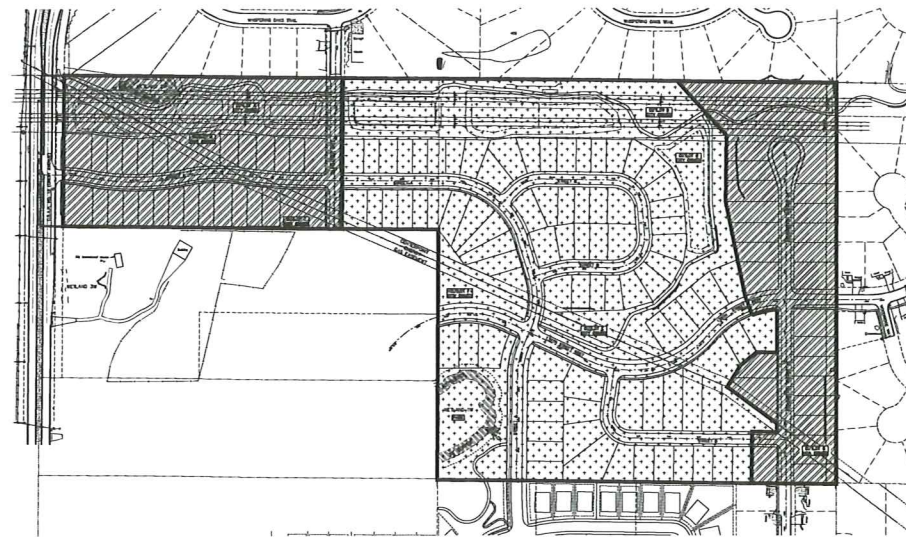
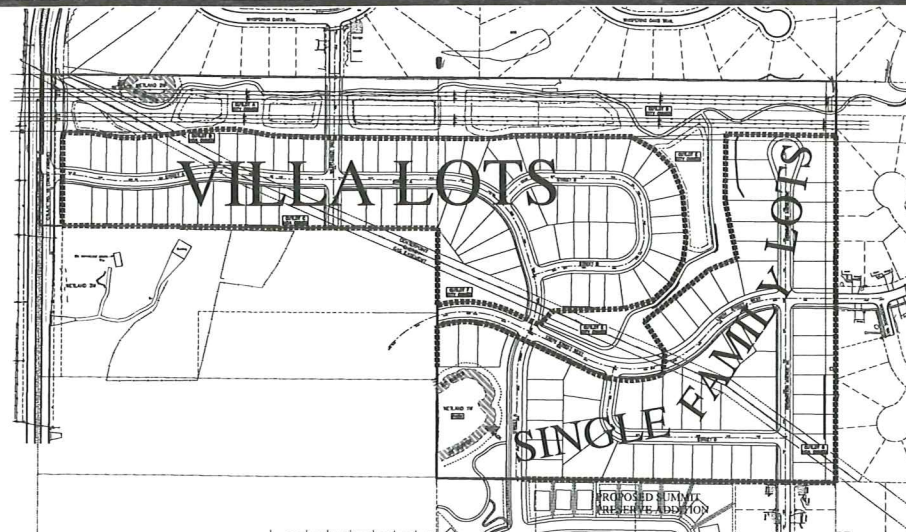

BENCH MARK
TIN SW QUAD OF 138TH ST.
& WOODRIDGE WAY
ELEV=1052.30

04-ENG-11630-SHEET-SITE-OVERALL

CITY PROJECT #DEV17-000002

PIONEERengineering

ENGINEERS LAND PLANNERS LAND SURVEYORS LANDSCAPE ARCHITECTS
2422 Enterprise Drive (651) 681-1914
Mendota Heights, MN 55120 Fax: 651-681-2488
www.pioneereng.com

I hereby certify that this plan was prepared by me or under my direct supervision and that I am a duly Licensed Professional Engineer under the laws of the State of Minnesota.

Name: Brian M. Melton
Reg. No.: 47504 Date: 01/22/2017

Project: 11-241-17 City Contracts
Designed: NAF
Drawn: NCR

Date: 01/22/17
Designed: NAF
Drawn: NCR

OVERALL PUD/SITE PLAN

M/HOMES
941 HILLWEND ROAD NE SUITE 300
PRIDLEY, MINNESOTA 55432

HAVEN RIDGE
PRIOR LAKE, MINNESOTA

9 OF 34

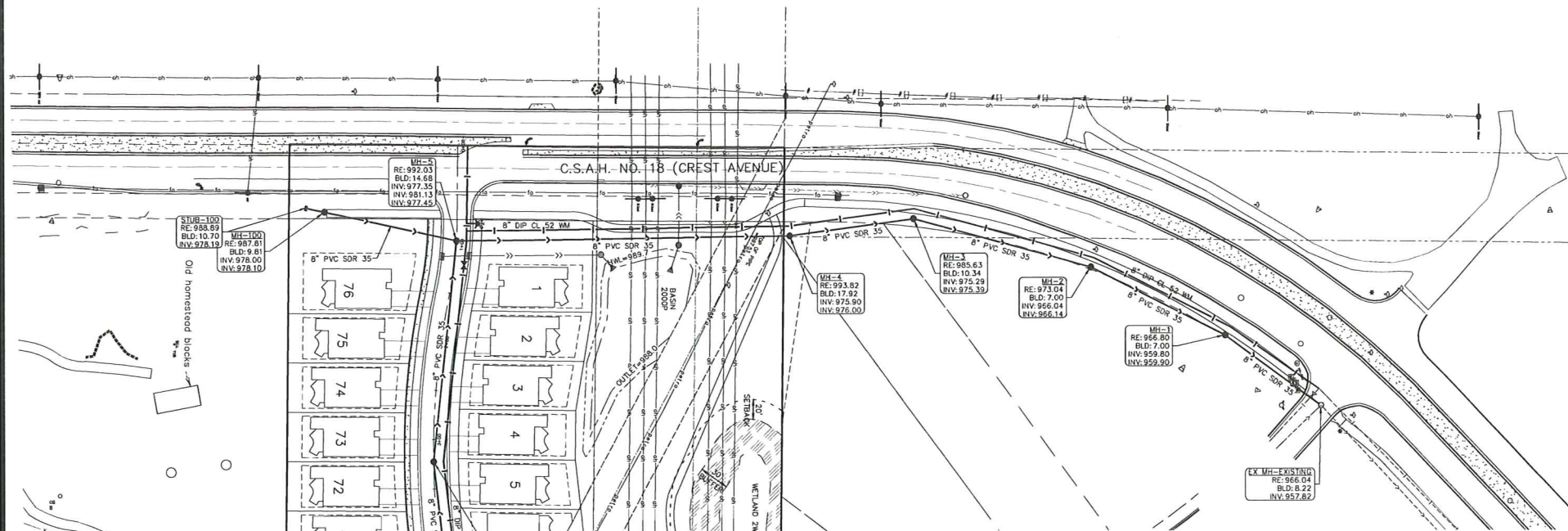

PIONEERengineering

2422 Enterprise Drive
Mendota Heights, MN 55120
(651) 681-1914
Fax: (651) 681-9488
www.pioneereng.com

I hereby certify that this plan was prepared by me or under my direct supervision and that I am a duly Licensed Professional Engineer under the laws of the State of Minnesota.

Name: Blair M. McNamee
Reg. No.: 47304
Date: 05/02/2017

Reviewed by:
1. John W. City City Engineer
2. John W. City Engineer

Date: 05/02/17
Designed: MAP
Drawn: NCR

PRELIMINARY SANITARY & WATERMAIN PLAN

CITY PROJECT #DEV17-000002

M/D HOMES
541 HILLWIND ROAD NE SUITE 300
FRIDLEY, MINNESOTA 55432

HAVEN RIDGE
PRIOR LAKE, MINNESOTA

28 OF 34

BENCH MARK
TIN SW QUAD OF 138TH ST.
& WOODRIDGE WAY
ELEVATION 1052.30



05-ENG-11470-SHEET-SWIR



SHAKOPEE PUBLIC UTILITIES COMMISSION

"Lighting the Way - Yesterday, Today and Beyond"

MEMORANDUM

TO: John R. Crooks, Utilities Manager 
FROM: Lon R. Schemel, Water Superintendent 
SUBJECT: Nitrate Results Update -- Advisory
DATE: July 5, 2017

Attached are the latest nitrate test results for the wells. The analyses provided are for the prior 2 years of data collected with trend graphs.

Shakopee Public Utilities Commission
Water Department
Nitrate Results
Reported in mg/L

Location	Sample Collected	Results Received	Results	Lab	Run Time
2	6/9/15	6/16/15	2.43	MVTL	26 hrs prior
2	9/8/15	9/15/15	2.27	MVTL	132 hrs prior
2	10/13/15	10/19/15	1.03	MVTL	96 hrs prior
2	12/8/15	2/1/16	5.04	MVTL	132 hrs prior
2	1/12/16	1/25/16	2.22	MVTL	220 hrs prior
2	3/8/16	3/14/16	5.93	MVTL	168 hrs prior
2	3/8/16	8/30/16	6.10	MDH	
2	3/29/16	4/4/16	2.96	MVTL	312 hrs prior
2	4/12/16	4/19/16	4.05	MVTL	48 hrs prior
2	5/10/16	5/16/16	2.60	MVTL	144 hrs prior
2	5/10/16	6/2/16	2.60	MDH	
2	6/14/16	6/20/16	2.32	MVTL	168 hrs prior
2	6/14/16	7/22/16	2.40	MDH	
2	8/9/16	8/22/16	2.60	MVTL	132 hrs prior
2	9/13/16	9/28/16	2.94	MVTL	168 hrs prior
2	9/13/16	10/24/16	2.90	MDH	
2	10/11/16	10/17/16	2.42	MVTL	192 hrs prior
2	11/8/16	11/17/16	3.28	MVTL	168 hrs prior
2	12/13/16	12/19/16	4.82	MVTL	192 hrs prior
2	12/13/16	2/9/17	4.30	MDH	
2	1/10/17	1/20/17	2.73	MVTL	168 hrs prior
2	2/14/17	3/6/17	3.02	MVTL	168 hrs prior
2	3/14/17	3/23/17	3.98	MVTL	168 hrs prior
2	3/14/17	4/24/17	3.70	MDH	
2	5/9/17	5/25/17	4.33	MVTL	168 hrs prior
2	6/8/17	6/28/17	3.30	MDH	168 hrs prior
2	6/13/17	6/20/17	6.28	MVTL	192 hrs prior

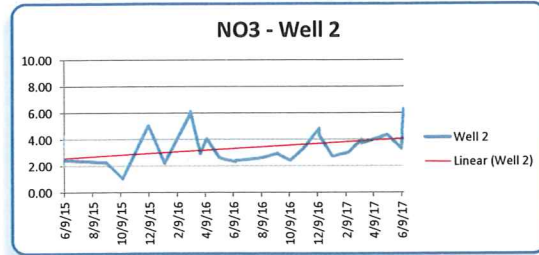

4	7/21/15	7/29/15	5.10	MVTL	220 hrs prior
4	11/3/15	11/9/15	6.85	MVTL	168 hrs prior
4	11/3/15	4/29/16	6.70	MDH	
4	2/9/16	2/16/16	7.18	MVTL	112 hrs prior
4	2/9/16	4/29/16	7.30	MDH	
4	3/8/16	3/14/16	6.31	MVTL	144 hrs prior
4	3/8/16	8/30/16	6.60	MDH	
4	5/17/16	5/25/16	6.33	MVTL	168 hrs prior
4	5/17/16	11/10/16	5.60	MDH	
4	6/14/16	6/20/16	5.35	MVTL	168 hrs prior
4	7/5/16	7/12/16	5.37	MVTL	168 hrs prior
4	7/5/16	11/10/16	5.10	MDH	
4	6/14/16	7/22/16	5.60	MDH	
4	9/6/16	9/12/16	4.73	MVTL	220 hrs prior
4	9/6/16	2/9/17	4.70	MDH	
4	10/11/16	10/17/16	5.04	MVTL	168 hrs prior
4	10/11/16	11/10/16	5.00	MDH	
4	12/20/16	12/27/16	5.57	MVTL	168 hrs prior
4	12/20/16	2/9/17	5.40	MDH	
4	1/3/17	1/16/17	6.15	MVTL	168 hrs prior
4	1/3/17	5/4/17	5.80	MDH	
4	2/7/17	2/14/17	5.84	MVTL	168 hrs prior
4	3/7/17	3/16/17	5.42	MVTL	168 hrs prior
4	3/7/17	4/24/17	5.60	MDH	
4	4/4/17	4/10/17	5.91	MVTL	168 hrs prior
4	5/2/17	5/10/17	5.10	MVTL	168 hrs prior
4	6/6/17	6/14/17	4.33	MVTL	168 hrs prior

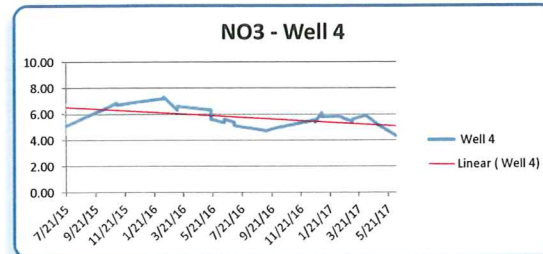

5	11/3/15	11/9/15	8.78	MVTL	112 hrs prior
5	11/3/15	4/29/16	8.80	MDH	
5	2/9/16	2/16/16	8.18	MVTL	434 hrs prior
5	2/9/16	4/29/16	8.50	MDH	
5	3/8/16	3/14/16	8.62	MVTL	288 hrs prior
5	3/8/16	8/30/16	8.80	MDH	
5	5/17/16	5/25/16	8.96	MVTL	168 hrs prior
5	5/17/16	11/10/16	8.00	MDH	
5	6/14/16	6/20/16	8.08	MVTL	168 hrs prior
5	6/14/16	7/22/16	8.30	MDH	
5	9/6/16	9/12/16	8.30	MVTL	96 hrs prior
5	9/6/16	2/9/17	8.10	MDH	
5	10/11/16	10/17/16	8.03	MVTL	168 hrs prior
5	10/11/16	11/10/16	7.90	MDH	
5	12/20/16	12/27/16	7.94	MVTL	168 hrs prior
5	12/20/16	2/9/17	7.70	MDH	
5	1/3/17	1/16/17	8.80	MVTL	168 hrs prior
5	1/3/17	5/4/17	8.30	MDH	
5	2/7/17	2/14/17	8.39	MVTL	168 hrs prior
5	3/7/17	3/18/17	8.22	MVTL	168 hrs prior
5	3/7/17	4/24/17	8.00	MDH	
5	4/4/17	4/10/17	8.12	MVTL	168 hrs prior
5	5/2/17	5/10/17	8.04	MVTL	168 hrs prior
5	6/6/17	6/14/17	7.12	MVTL	168 hrs prior

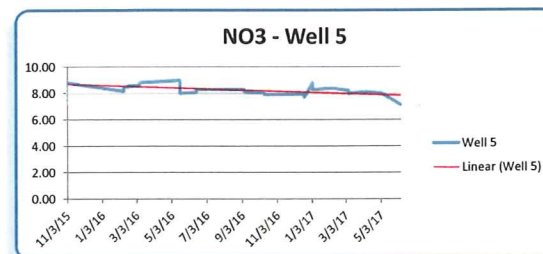

Shakopee Public Utilities Commission
Water Department
Nitrate Results
Reported in mg/L

Location	Sample Collected	Results Received	Results	Lab	Run Time
6	3/17/15	3/30/15	5.61	MVTL	48 hrs prior
6	6/9/15	6/16/15	5.94	MVTL	96 hrs prior
6	7/21/15	7/29/15	4.86	MVTL	144 hrs prior
6	8/18/15	8/24/15	4.88	MVTL	696 hrs prior
6	9/8/15	9/15/15	4.89	MVTL	288 hrs prior
6	10/13/15	10/19/15	4.93	MVTL	192 hrs prior
6	11/17/15	11/23/15	5.15	MVTL	144 hrs prior
6	6/7/16	6/14/16	5.04	MVTL	195 hrs prior
6	6/7/16	7/22/16	4.90	MDH	
6	9/13/16	9/28/16	4.64	MVTL	216 hrs prior
6	9/13/16	10/24/16	4.70	MDH	
6	12/13/16	12/19/16	4.60	MVTL	240 hrs prior
6	12/13/16	2/9/17	4.10	MDH	
6	3/14/17	4/24/17	4.40	MDH	168 hrs prior
6	4/11/17	4/17/17	4.94	MVTL	168 hrs prior

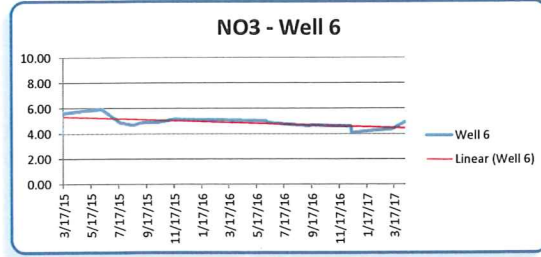

7	3/10/15	3/16/15	5.52	MVTL	352 hrs prior
7	5/19/15	5/26/15	5.75	MVTL	158 hrs prior
7	6/2/15	6/8/15	5.66	MVTL	96 hrs prior
7	7/7/15	7/20/15	5.14	MVTL	144 hrs prior
7	8/11/15	8/17/15	4.77	MVTL	96 hrs prior
7	9/1/15	9/9/15	5.18	MVTL	144 hrs prior
7	10/6/15	10/14/15	5.41	MVTL	336 hrs prior
7	10/20/15	10/28/15	4.94	MVTL	144 hrs prior
7	11/10/15	11/16/15	5.24	MVTL	321 hrs prior
7	12/1/15	12/15/15	5.41	MVTL	352 hrs prior
7	2/2/16	2/8/16	5.29	MVTL	192 hrs prior
7	3/1/16	3/8/16	5.45	MVTL	140 hrs prior
7	3/1/16	8/30/16	5.40	MDH	
7	6/14/16	6/20/16	4.81	MVTL	188 hrs prior
7	6/14/16	7/22/16	5.00	MDH	
7	9/20/16	9/28/16	4.79	MVTL	216 hrs prior
7	9/20/16	10/24/16	4.50	MDH	
7	10/4/16	10/12/16	4.89	MVTL	216 hrs prior
7	11/15/16	11/21/16	4.55	MVTL	168 hrs prior
7	12/13/16	12/19/16	4.55	MVTL	240 hrs prior
7	12/13/16	2/9/17	4.00	MDH	
7	3/14/17	4/24/17	4.50	MDH	168 hrs prior
7	4/11/17	4/17/17	4.74	MVTL	168 hrs prior

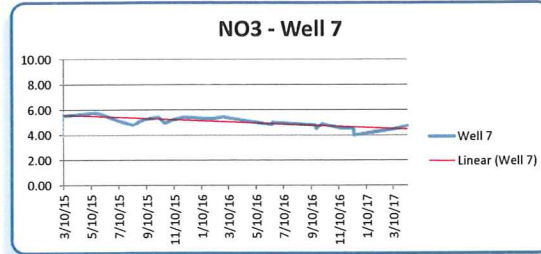

8	6/2/15	6/8/15	6.39	MVTL	192 hrs prior
8	7/14/15	7/20/15	0.05	MVTL	168 hrs prior
8	8/11/15	8/17/15	5.77	MVTL	120 hrs prior
8	9/1/15	9/9/15	6.24	MVTL	180 hrs prior
8	10/6/15	10/14/15	6.55	MVTL	192 hrs prior
8	11/3/15	11/9/15	6.46	MVTL	140 hrs prior
8	11/3/15	4/29/16	6.50	MDH	
8	12/1/15	12/15/15	6.46	MVTL	312 hrs prior
8	1/5/16	1/13/16	6.00	MVTL	96 hrs prior
8	2/2/16	2/8/16	6.24	MVTL	144 hrs prior
8	2/2/16	4/29/16	6.20	MDH	
8	3/1/16	3/8/16	6.43	MVTL	96 hrs prior
8	3/1/16	8/30/16	6.70	MDH	
8	4/5/16	4/22/16	6.46	MVTL	336 hrs prior
8	5/3/16	5/9/16	6.30	MVTL	124 hrs prior
8	5/3/16	11/10/16	6.40	MDH	
8	6/7/16	6/14/16	6.44	MVTL	310 hrs prior
8	6/7/16	7/22/16	6.30	MDH	
8	7/5/16	7/12/16	6.40	MVTL	190 hrs prior
8	7/5/16	11/10/16	6.10	MDH	
8	8/2/16	8/9/16	6.33	MVTL	192 hrs prior
8	9/6/16	9/12/16	6.36	MVTL	140 hrs prior
8	9/6/16	2/9/17	6.40	MDH	
8	10/4/16	10/12/16	6.48	MVTL	168 hrs prior
8	10/4/16	11/10/16	6.30	MDH	
8	11/1/16	11/7/16	6.20	MVTL	144 hrs prior
8	12/6/16	12/12/16	6.17	MVTL	216 hrs prior
8	12/20/16	12/27/16	5.95	MVTL	168 hrs prior
8	12/20/16	2/9/17	5.70	MDH	
8	1/3/17	1/16/17	6.59	MVTL	168 hrs prior
8	1/3/17	5/4/17	6.40	MDH	
8	2/7/17	2/14/17	6.08	MVTL	168 hrs prior
8	3/7/17	3/18/17	6.16	MVTL	168 hrs prior
8	3/7/17	4/24/17	6.20	MDH	
8	4/4/17	4/10/17	6.07	MVTL	216 hrs prior
8	5/2/17	5/10/17	6.22	MVTL	168 hrs prior
8	6/6/17	6/14/17	5.71	MVTL	168 hrs prior

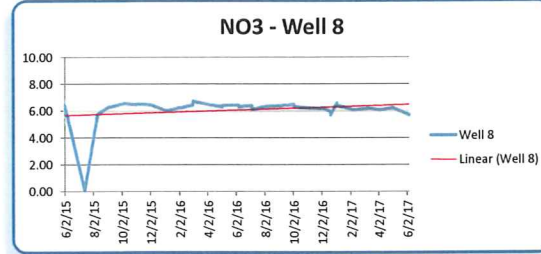

Shakopee Public Utilities Commission
Water Department
Nitrate Results
Reported in mg/L

Location	Sample Collected	Results Received	Results	Lab	Run Time
9	6/9/15	6/16/15	4.29	MVTL	24 hrs prior
9	7/7/15	7/20/15	3.62	MVTL	192 hrs prior
9	8/18/15	8/24/15	3.54	MVTL	24 hrs prior
9	9/1/15	9/9/15	3.75	MVTL	161 hrs prior
9	10/13/15	10/19/15	3.57	MVTL	150 hrs prior
9	12/8/15	2/1/16	3.28	MVTL	144 hrs prior
9	1/5/16	1/13/16	3.54	MVTL	168 hrs prior
9	2/16/16	2/23/16	3.40	MVTL	312 hrs prior
9	3/15/16	3/21/16	3.48	MVTL	168 hrs prior
9	4/19/16	4/25/16	3.48	MVTL	168 hrs prior
9	5/17/16	5/25/16	3.58	MVTL	212 hrs prior
9	5/17/16	6/2/16	3.30	MDH	
9	6/21/16	6/28/16	3.51	MVTL	144 hrs prior
9	7/19/16	7/25/16	3.47	MVTL	168 hrs prior
9	8/16/16	8/22/16	3.49	MVTL	192 hrs prior
9	9/20/16	9/28/16	3.39	MVTL	240 hrs prior
9	10/18/16	10/24/16	3.27	MVTL	168 hrs prior
9	11/15/16	11/21/16	3.32	MVTL	168 hrs prior
9	12/20/16	12/27/16	2.81	MVTL	144 hrs prior
9	1/17/17	1/27/17	3.49	MVTL	168 hrs prior
9	2/21/17	3/3/17	3.46	MVTL	168 hrs prior
9	3/21/17	3/27/17	4.06	MVTL	168 hrs prior
9	4/18/17	4/24/17	3.09	MVTL	168 hrs prior
9	5/16/17	5/25/17	3.47	MVTL	168 hrs prior
9	6/5/17	6/28/17	3.40	MDH	168 hrs prior
9	6/20/17	6/27/17	3.69	MVTL	168 hrs prior
10	4/17/12	4/20/12	< 1.00	TCWC	158 hrs prior
10	1/21/14	1/29/14	< 1.00	TCWC	144 hrs prior
10	3/25/14	4/1/14	3.61	MVTL	96 hrs prior
10	4/23/14	5/7/14	< 0.20	MVTL	24 hrs prior
10	4/23/14	6/16/14	< 0.05	MDH	*
10	6/16/15	6/26/15	< 0.05	MVTL	144 hrs prior
10	4/11/17	4/17/17	< 0.05	MVTL	
11	6/2/15	6/8/15	3.46	MVTL	100 hrs prior
11	7/21/15	7/29/15	3.05	MVTL	288 hrs prior
11	8/11/15	8/17/15	2.90	MVTL	144 hrs prior
11	9/8/15	9/15/15	3.17	MVTL	144 hrs prior
11	10/6/15	10/14/15	3.36	MVTL	300 hrs prior
11	12/22/15	12/30/15	2.71	MVTL	168 hrs prior
11	1/12/16	1/25/16	2.92	MVTL	192 hrs prior
11	2/23/16	2/29/16	3.20	MVTL	132 hrs prior
11	3/1/16	3/8/16	3.23	MVTL	60 hrs prior
11	4/26/16	5/2/16	2.99	MVTL	192 hrs prior
11	4/26/16	5/26/16	2.90	MDH	
11	5/24/16	6/2/16	3.02	MVTL	264 hrs prior
11	6/28/16	7/6/16	2.42	MVTL	216 hrs prior
11	7/28/16	8/1/16	2.40	MVTL	126 hrs prior
11	8/23/16	8/31/16	2.85	MVTL	168 hrs prior
11	9/27/16	10/3/16	2.89	MVTL	168 hrs prior
11	10/25/16	10/31/16	2.84	MVTL	192 hrs prior
11	11/22/16	12/1/16	2.15	MVTL	216 hrs prior
11	12/27/16	1/4/17	2.86	MVTL	168 hrs prior
11	1/24/17	2/7/17	2.72	MVTL	216 hrs prior
11	2/28/17	3/8/17	2.77	MVTL	168 hrs prior
11	3/28/17	4/3/17	2.87	MVTL	168 hrs prior
11	4/25/17	5/4/17	2.67	MVTL	216 hrs prior
11	5/23/17	5/30/17	2.83	MVTL	168 hrs prior
11	6/1/17	6/15/17	2.90	MDH	192 hrs prior
11	6/27/17	7/5/17	2.50	MVTL	168 hrs prior
12	12/17/13	12/23/13	3.01	TCWC	144 hrs prior
12	1/21/14	1/29/14	1.70	TCWC	168 hrs prior
12	2/4/14	2/10/14	2.21	TCWC	144 hrs prior
12	4/23/14	5/7/14	1.27	MVTL	192 hrs prior
12	4/23/14	6/16/14	1.30	MDH	*
12	8/12/14	8/20/14	2.10	MVTL	162 hrs prior
12	9/23/14	10/2/14	2.28	MVTL	132 hrs prior
12	10/13/15	10/19/15	2.35	MVTL	126 hrs prior
12	4/11/17	4/17/17	0.92	MVTL	
13	3/12/09	3/26/09	0.96	MVTL	46 hrs prior
13	4/14/09	4/27/09	1.10	MVTL	60 hrs prior
13	8/4/09	8/12/09	0.90	MVTL	1013 hrs prior
13	9/24/09	10/5/09	0.98	MVTL	51 hrs prior
13	7/14/10	7/27/10	1.07	MVTL	42 hrs prior
13	3/11/11	3/16/11	1.08	MVTL	100 hrs prior
13	4/11/17	4/17/17	1.19	MVTL	

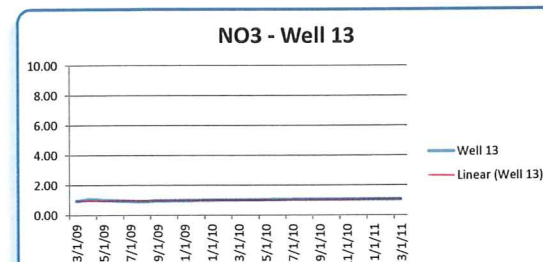
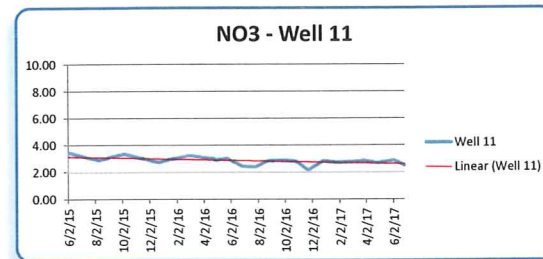
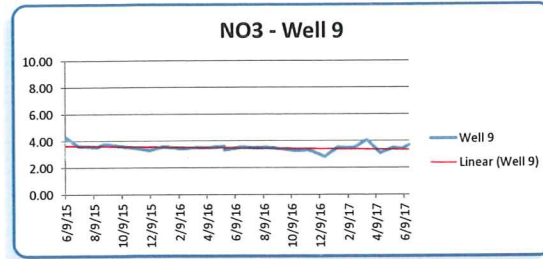

Shakopee Public Utilities Commission
Water Department
Nitrate Results
Reported in mg/L

Location	Sample Collected	Results Received	Results	Lab	Run Time
14	3/11/11	3/16/11	< 0.20	MVTL	90 hrs prior
14	2/12/13	2/19/13	Absent	TCWC	126 hrs prior
14	1/21/14	1/29/14	< 1.00	TCWC	168 hrs prior
14	4/23/14	5/7/14	< 0.20	MVTL	24 hrs prior
14	4/23/14	6/16/14	< 0.05	MDH	*
14	4/11/17	4/17/17	< 0.05	MVTL	
15	7/28/15	8/3/15	4.49	MVTL	96 hrs prior
15	8/4/15	8/10/15	4.58	MVTL	144 hrs prior
15	9/1/15	9/9/15	4.91	MVTL	200 hrs prior
15	10/13/15	10/19/15	5.05	MVTL	132 hrs prior
15	11/17/15	11/23/15	5.50	MVTL	336 hrs prior
15	1/5/16	1/13/16	5.15	MVTL	312 hrs prior
15	12/8/15	2/1/16	5.33	MVTL	168 hrs prior
15	2/16/16	2/23/16	4.86	MVTL	144 hrs prior
15	2/23/16	2/29/16	5.16	MVTL	172 hrs prior
15	3/22/16	3/28/16	5.36	MVTL	72 hrs prior
15	4/5/16	4/22/16	5.20	MVTL	144 hrs prior
15	5/3/16	5/9/16	5.00	MVTL	288 hrs prior
15	5/3/16	5/26/16	5.00	MDH	
15	7/19/16	7/25/16	5.52	MVTL	144 hrs prior
15	8/2/16	8/9/16	5.29	MVTL	120 hrs prior
15	9/27/16	10/3/16	5.41	MVTL	216 hrs prior
15	10/18/16	10/24/16	5.48	MVTL	216 hrs prior
15	11/1/16	11/7/16	5.08	MVTL	192 hrs prior
15	12/6/16	12/12/16	4.38	MVTL	168 hrs prior
15	1/24/17	2/7/17	5.58	MVTL	168 hrs prior
15	2/7/17	2/14/17	5.34	MVTL	168 hrs prior
15	3/28/17	4/3/17	5.35	MVTL	168 hrs prior
15	4/18/17	4/24/17	5.08	MVTL	168 hrs prior
15	5/2/17	5/10/17	5.50	MVTL	144 hrs prior
15	6/1/17	6/15/17	5.20	MDH	168 hrs prior
15	6/6/17	6/14/17	4.80	MVTL	168 hrs prior
16	5/5/15	5/18/15	5.61	MVTL	144 hrs prior
16	5/5/15	5/18/15	3.86	MVTL	144 hrs prior
16	5/19/15	5/26/15	5.70	MVTL	168 hrs prior
16	6/9/15	6/16/15	5.68	MVTL	120 hrs prior
16	7/21/15	7/29/15	4.98	MVTL	312 hrs prior
16	8/11/15	8/17/15	4.80	MVTL	144 hrs prior
16	9/8/15	9/15/15	5.17	MVTL	120 hrs prior
16	10/20/15	10/28/15	5.04	MVTL	48 hrs prior
16	11/10/15	11/16/15	5.33	MVTL	172 hrs prior
16	11/10/15	4/29/16	5.40	MDH	
16	12/15/15	12/21/15	5.92	MVTL	144 hrs prior
16	1/26/16	2/1/16	5.48	MVTL	120 hrs prior
16	2/2/16	2/8/16	5.29	MVTL	312 hrs prior
16	2/2/16	4/29/16	5.30	MDH	
16	3/8/16	3/14/16	5.30	MVTL	168 hrs prior
16	3/8/16	8/30/16	5.40	MDH	
16	6/14/16	6/20/16	5.05	MVTL	360 hrs prior
16	6/14/16	7/22/16	5.40	MDH	
16	7/5/16	7/12/16	5.45	MVTL	312 hrs prior
16	8/16/16	8/22/16	7.01	MVTL	120 hrs prior
16	9/13/16	9/28/16	5.50	MVTL	168 hrs prior
16	9/13/16	10/24/16	5.50	MDH	
16	10/4/16	10/12/16	5.35	MVTL	168 hrs prior
16	10/4/16	11/10/16	5.20	MDH	
16	11/15/16	11/21/16	5.10	MVTL	144 hrs prior
16	12/13/16	12/19/16	5.63	MVTL	312 hrs prior
16	12/13/16	2/9/17	5.00	MDH	
16	1/3/17	1/16/17	5.49	MVTL	168 hrs prior
16	2/21/17	3/3/17	5.39	MVTL	168 hrs prior
16	3/14/17	4/24/17	4.90	MDH	168 hrs prior
16	4/4/17	4/10/17	5.17	MVTL	168 hrs prior
16	5/16/17	5/25/17	5.07	MVTL	168 hrs prior

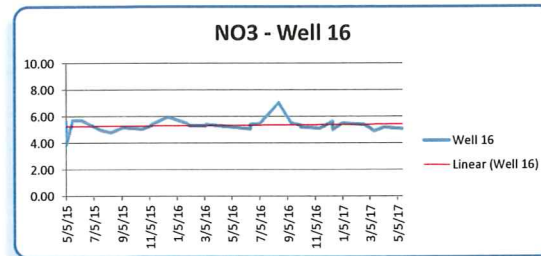
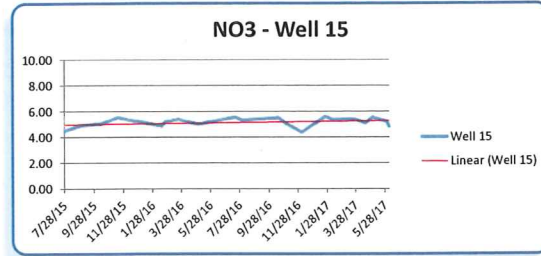

Shakopee Public Utilities Commission
Water Department
Nitrate Results
Reported in mg/L

Location	Sample Collected	Results Received	Results	Lab	Run Time
17	3/31/15	4/13/15	5.84	MVTL	168 hrs prior
17	4/23/15	7/8/15	6.00	MDH	211 hrs prior
17	4/21/15	4/27/15	6.82	MVTL	168 hrs prior
17	5/12/15	5/18/15	6.85	MVTL	312 hrs prior
17	6/2/15	6/8/15	5.57	MVTL	24 hrs prior
17	7/14/15	7/20/15	0.05	MVTL	144 hrs prior
17	8/25/15	9/1/15	5.31	MVTL	192 hrs prior
17	9/15/15	9/22/15	5.52	MVTL	312 hrs prior
17	10/27/15	11/5/15	5.95	MVTL	168 hrs prior
17	11/3/15	11/9/15	5.66	MVTL	144 hrs prior
17	11/3/15	4/29/16	5.60	MDH	
17	12/1/15	12/15/15	5.67	MVTL	168 hrs prior
17	1/19/16	1/26/16	5.73	MVTL	144 hrs prior
17	2/9/16	2/16/16	6.51	MVTL	180 hrs prior
17	2/9/16	4/29/16	6.80	MDH	
17	3/15/16	3/21/16	5.52	MVTL	288 hrs prior
17	3/15/16	8/30/16	5.80	MDH	
17	4/26/16	5/2/16	6.02	MVTL	172 hrs prior
17	5/24/16	6/2/16	5.63	MVTL	144 hrs prior
17	6/21/16	6/20/16	7.04	MVTL	312 hrs prior
17	6/21/16	8/30/16	6.50	MDH	
17	7/12/16	7/18/16	5.98	MVTL	216 hrs prior
17	7/12/16	11/10/16	6.00	MDH	
17	8/2/16	8/9/16	5.62	MVTL	120 hrs prior
17	9/20/16	9/28/16	5.64	MVTL	216 hrs prior
17	9/20/16	10/24/16	5.30	MDH	
17	10/11/16	10/17/16	5.54	MVTL	144 hrs prior
17	10/11/16	11/10/16	5.40	MDH	
17	11/22/16	12/1/16	5.44	MVTL	192 hrs prior
17	12/20/16	12/27/16	5.53	MVTL	192 hrs prior
17	12/20/16	2/9/17	5.70	MDH	
17	1/10/17	1/20/17	5.61	MVTL	168 hrs prior
17	1/10/17	5/4/17	5.50	MDH	
17	2/28/17	3/8/17	5.75	MVTL	168 hrs prior
17	3/7/17	3/18/17	6.05	MVTL	168 hrs prior
17	3/7/17	4/24/17	5.90	MDH	

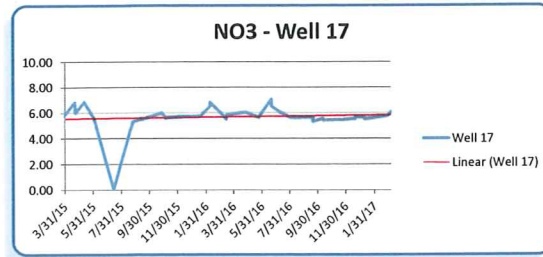

20	6/9/15	6/16/15	3.36	MVTL	162 hrs prior
20	7/28/15	8/3/15	2.82	MVTL	120 hrs prior
20	8/11/15	8/17/15	2.71	MVTL	211 hrs prior
20	9/1/15	9/9/15	2.99	MVTL	180 hrs prior
20	10/27/15	11/5/15	3.11	MVTL	120 hrs prior
20	11/10/15	11/16/15	2.90	MVTL	288 hrs prior
20	12/8/15	2/1/16	2.83	MVTL	120 hrs prior
20	1/19/16	1/26/16	2.78	MVTL	165 hrs prior
20	3/15/16	3/21/16	2.48	MVTL	162 hrs prior
20	4/19/16	4/25/16	2.81	MVTL	216 hrs prior
20	5/17/16	5/25/16	3.02	MVTL	120 hrs prior
20	5/17/16	6/2/16	2.80	MDH	
20	6/21/16	6/28/16	3.03	MVTL	768 hrs prior
20	7/19/16	7/25/16	3.19	MVTL	144 hrs prior
20	8/16/16	8/22/16	3.23	MVTL	159 hrs prior
20	9/20/16	9/28/16	3.05	MVTL	216 hrs prior
20	10/18/16	10/24/16	2.20	MVTL	144 hrs prior
20	11/15/16	11/21/16	2.49	MVTL	192 hrs prior
20	12/27/16	1/4/17	2.79	MVTL	168 hrs prior
20	1/17/17	1/27/17	1.97	MVTL	168 hrs prior
20	2/21/17	3/3/17	2.60	MVTL	168 hrs prior
20	3/21/17	3/27/17	2.47	MVTL	168 hrs prior
20	4/18/17	4/24/17	2.40	MVTL	168 hrs prior
20	5/16/17	5/25/17	2.68	MVTL	168 hrs prior
20	6/5/17	6/28/17	2.50	MDH	144 hrs prior
20	6/20/17	6/27/17	2.30	MVTL	168 hrs prior

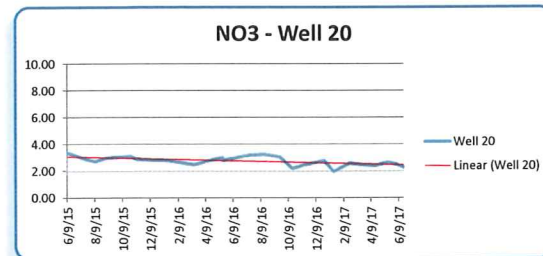

21	6/2/15	6/8/15	3.68	MVTL	168 hrs prior
21	7/7/15	7/20/15	3.36	MVTL	172 hrs prior
21	8/25/15	9/1/15	3.18	MVTL	312 hrs prior
21	10/20/15	10/28/15	3.37	MVTL	168 hrs prior
21	12/1/15	12/15/15	3.57	MVTL	165 hrs prior
21	1/12/16	2/16/16	2.77	MVTL	368 hrs prior
21	2/9/16	2/16/16	3.31	MVTL	144 hrs prior
21	3/1/16	3/8/16	2.98	MVTL	160 hrs prior
21	4/26/16	5/2/16	3.35	MVTL	165 hrs prior
21	4/26/16	5/26/16	3.30	MDH	
21	5/21/16	6/2/16	3.29	MVTL	312 hrs prior
21	6/14/16	6/20/16	3.12	MVTL	144 hrs prior
21	7/26/16	8/1/16	3.52	MVTL	211 hrs prior
21	8/23/16	8/31/16	3.57	MVTL	162 hrs prior
21	9/13/16	9/28/16	3.54	MVTL	216 hrs prior
21	9/13/16	10/24/16	3.40	MDH	
21	10/26/16	11/7/16	2.97	MVTL	120 hrs prior
21	11/22/16	12/1/16	2.98	MVTL	120 hrs prior
21	12/20/16	12/27/16	2.94	MVTL	144 hrs prior
21	12/20/16	2/9/17	2.90	MDH	
21	1/24/17	2/7/17	2.97	MVTL	168 hrs prior
21	2/28/17	3/8/17	2.98	MVTL	168 hrs prior
21	3/14/17	4/24/17	3.20	MDH	168 hrs prior
21	4/25/17	5/4/17	2.48	MVTL	168 hrs prior
21	6/6/17	6/28/17	3.20	MDH	144 hrs prior
21	6/27/17	7/5/17	3.48	MVTL	168 hrs prior

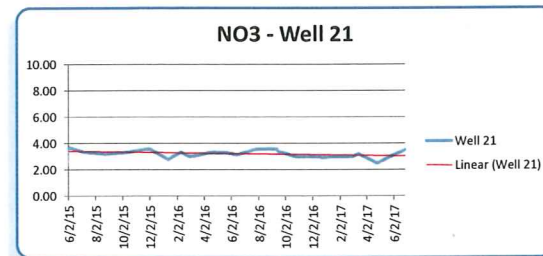

Shakopee Public Utilities Commission
Water Department
Nitrate Results
Reported in mg/L

Location	Sample Collected	Results Received	Results	Lab	Run Time
Combined Discharge - Wells 6-7-10					
CD 1	6/16/15	6/26/15	3.45	MVTL	212 hrs prior
CD 1	7/28/15	8/3/15	3.21	MVTL	24 hrs prior
CD 1	8/4/15	8/10/15	3.30	MVTL	368 hrs prior
CD 1	9/15/15	9/22/15	3.76	MVTL	168 hrs prior
CD 1	11/17/15	11/23/15	3.39	MVTL	160 hrs prior
CD 1	1/26/16	2/1/16	2.71	MVTL	168 hrs prior
CD 1	3/31/16	4/22/16	2.83	MVTL	211 hrs prior
CD 1	4/12/16	4/19/16	3.01	MVTL	180 hrs prior
CD 1	5/10/16	5/16/16	3.25	MVTL	120 hrs prior
CD 1	5/10/16	6/2/16	3.20	MDH	
CD 1	6/21/16	6/28/16	3.23	MVTL	162 hrs prior
CD 1	7/12/16	7/18/16	3.26	MVTL	212 hrs prior
CD 1	8/9/16	8/22/16	3.17	MVTL	165 hrs prior
CD 1	9/13/16	9/28/16	3.07	MVTL	168 hrs prior
CD 1	10/25/16	10/31/16	3.01	MVTL	144 hrs prior
CD 1	11/8/16	11/17/16	3.14	MVTL	368 hrs prior
CD 1	12/13/16	12/18/16	2.95	MVTL	168 hrs prior
CD 1	1/10/17	1/20/17	2.96	MVTL	168 hrs prior
CD 1	2/14/17	3/6/17	4.35	MVTL	168 hrs prior
CD 1	3/14/17	3/23/17	3.11	MVTL	168 hrs prior
CD 1	4/11/17	4/17/17	3.11	MVTL	120 hrs prior
CD 1	5/9/17	5/25/17	3.19	MVTL	212 hrs prior
CD 1	6/5/17	6/28/17	2.60	MDH	168 hrs prior
CD 1	6/13/17	6/20/17	3.03	MVTL	168 hrs prior

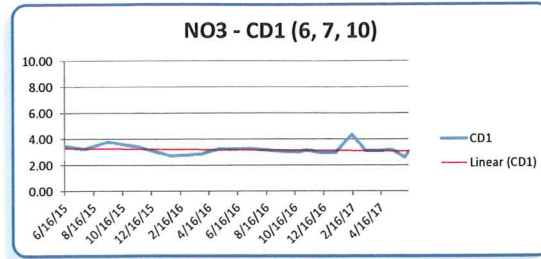

Combined Discharge - Wells 12-13-14					
CD 2	6/16/2015	6/26/2015	1.26	MVTL	126 hrs prior
CD 2	8/4/2015	8/10/2015	1.35	MVTL	168 hrs prior
CD 2	9/15/2015	9/22/2015	1.15	MVTL	144 hrs prior
CD 2	10/6/2015	10/14/2015	1.25	MVTL	208 hrs prior
CD 2	12/22/2015	12/30/2015	1.03	MVTL	168 hrs prior
CD 2	1/5/2016	1/13/2016	1.08	MVTL	192 hrs prior
CD 2	2/23/2016	2/29/2016	1.03	MVTL	208 hrs prior
CD 2	3/22/2016	3/28/2016	0.96	MVTL	288 hrs prior
CD 2	4/12/2016	4/19/2016	1.07	MVTL	120 hrs prior
CD 2	5/10/2016	5/16/2016	0.98	MVTL	165 hrs prior
CD 2	5/10/2016	6/2/2016	0.97	MDH	
CD 2	7/12/2016	7/18/2016	0.93	MVTL	170 hrs prior
CD 2	10/11/2016	10/17/2016	0.87	MVTL	168 hrs prior
CD 2	11/8/2016	11/17/2016	0.91	MVTL	168 hrs prior
CD 2	1/10/2017	1/20/2017	0.92	MVTL	216 hrs prior
CD 2	4/11/2017	4/17/2017	0.85	MVTL	144 hrs prior
CD 2	6/8/2017	6/28/2017	0.86	MDH	144 hrs prior

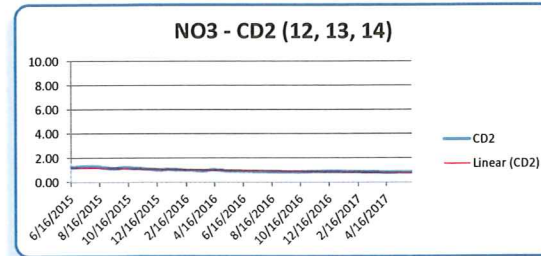

Monthly Water Dashboard

As of: June 2017

Shakopee Public Utilities Commission

ALL VALUES IN MILLIONS OF GALLONS

Element/Measure

Water Pumped/Metered

Averages

2014	140
2015	138
2016	145

Last 6 months actuals	92	82	92	96	149	256
-----------------------	----	----	----	----	-----	-----

2016

2017

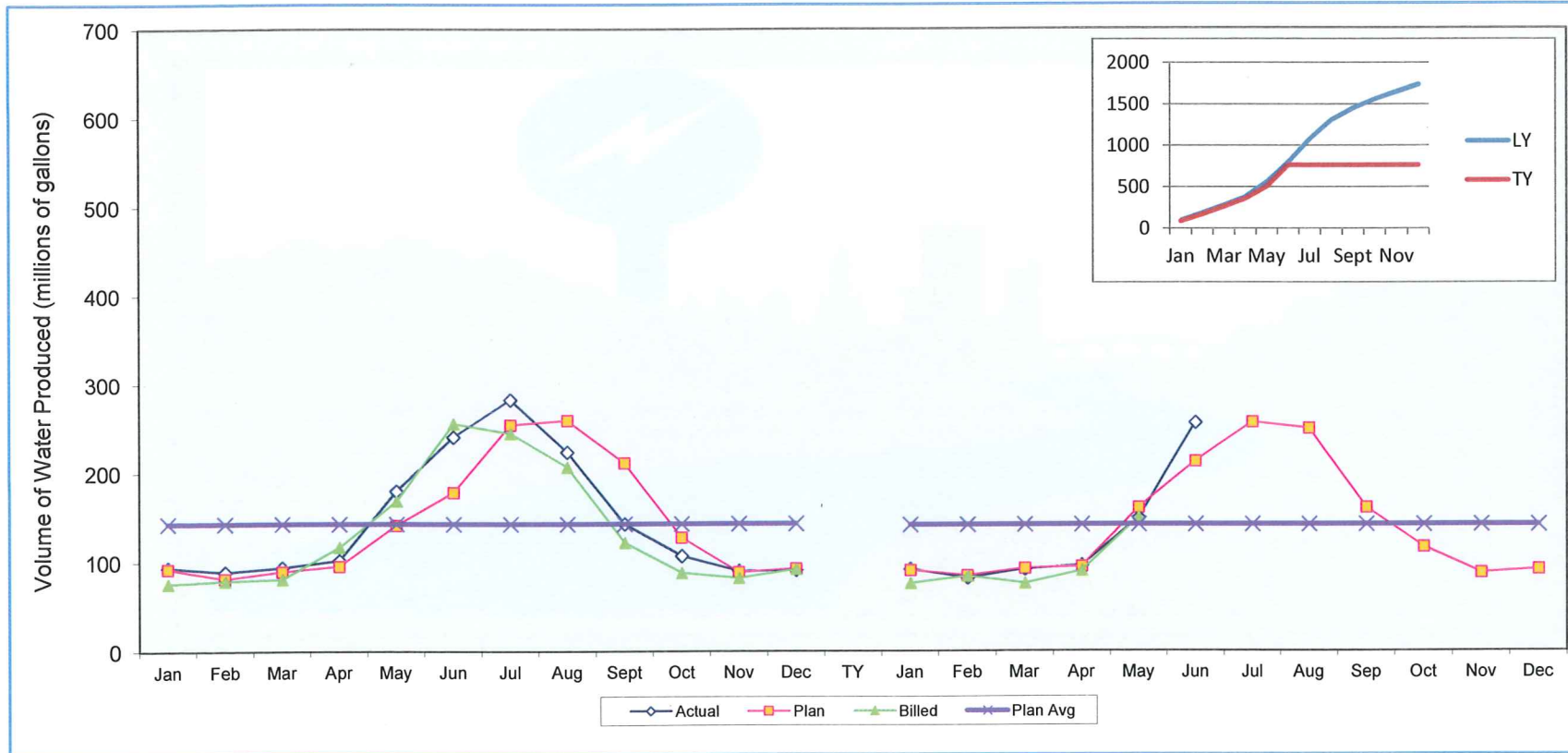

	LY	Jan	Feb	Mar	Apr	May	Jun	Jul	Aug	Sept	Oct	Nov	Dec	TY	Jan	Feb	Mar	Apr	May	Jun	Jul	Aug	Sep	Oct	Nov	Dec
Actual		94	89	94	102	180	241	283	224	143	107	90	91		92	82	92	96	149	256						
Plan		93	82	90	96	142	179	255	260	212	128	89	93		91	85	93	95	161	213	257	250	161	117	88	92
YTD % *															101%	99%	99%	99%	97%	104%						
Billed		76	79	81	117	169	256	245	207	122	88	82	92		76	84	76	90	150							

* Actual gallons pumped vs. Plan

**SHAKOPEE PUBLIC UTILITIES
MEMORANDUM**

TO: SHAKOPEE PUBLIC UTILITIES COMMISSION

FROM: JOHN R. CROOKS, UTILITIES MANAGER 

SUBJECT: JUNE 2017 MMPA BOARD MEETING SUMMARY

DATE: JULY 13, 2017

The Board of Directors of the Minnesota Municipal Power Agency (MMPA) met on June 27, 2017 at the offices of Shakopee Public Utilities in Shakopee, Minnesota.

The Board discussed the rollout of Clean Energy Choice for Business, which is scheduled for next month.

The Board discussed the status of the renewable projects that the Agency is pursuing.

The success of MMPA'S 2017 Energy Education program was discussed. Fourth graders from all twelve MMPA member communities participated in either the FEP tour event or local education assemblies.

The Board also discussed the grand opening for Shakopee Energy Park on Thursday, July 27, 2017, beginning at 4pm.

**SHAKOPEE PUBLIC UTILITIES
MEMORANDUM**

TO: SHAKOPEE PUBLIC UTILITIES COMMISSSION

FROM: JOHN R. CROOKS, UTILITIES MANAGER 

SUBJECT: SMART GRID BUSINESS CASE AND TECHNOLOGY
ROADMAP FOR SHAKOPEE PUBLIC UTILITIES

DATE: JULY 13, 2017

The Smart Grid Business Case identifies costs, benefits and an implementation roadmap for the Electric, Water, Finance, Customer Service and Engineering Departments. SPUC staff, over a series of 2 months in 2011, provided information in preparing the detailed Smart Grid Business Case analysis. WMP had qualified experience in the Smart Grid sector, working with solutions and analysis for utilities beginning the transformation to the Smart Grid.

An overview of the Report will be provided and general discussion will take place to determine the next steps in the development of enabling technologies.



Reminder: Please bring the report provided on July 17 for reference.



SHAKOPEE PUBLIC UTILITIES

"Lighting the Way – Yesterday, Today and Beyond"

July 12, 2017

TO: John Crooks 
CC: Joe Adams
Sherri Anderson
Greg Drent
Lon Schemel
Sharon Walsh 
FROM: Renee Schmid, Director of Finance and Administration
SUBJECT: Financial Results for June, 2017

The following Financial Statements are attached for your review and approval.

Month to Date and Year to Date Financial Results – June, 2017

- Combined Statement of Revenue & Expense and Net Assets – Electric, Water and Total Utility
- Electric Operating Revenue & Expense Detail
- Water Operating Revenue & Expense Detail

Key items to note:

Month to Date Results – June, 2017

- Total Utility Operating Revenues for the month of June totaled \$4.0 million and were unfavorable to budget by \$441k or 10.0%. Electric revenues were unfavorable to budget by \$400k or 10.2% driven by lower than plan energy sales in all revenue groups and lower than plan power cost adjustment revenue in all groups due to lower than plan purchased power costs. Water revenues were also unfavorable to budget by \$41k or 8.1% driven by lower than plan sales volumes in the commercial and industrial revenue groups.
- Total operating expenses were \$4.3 million and were favorable to budget by \$302k or 6.5%. Total purchased power costs in June were \$3.4 million and were \$95k or 2.7% lower than plan for the month. Total Operating Expense for electric including purchased power was favorable to budget by \$276k or 6.5% primarily due to lower than plan purchased power costs and timing of expenditures in energy conservation expense, administrative and general expense, and depreciation. Total Operating Expense for Water was also favorable to budget by \$27k or 7.1% due timing of expenditures in administrative and general expense and depreciation, which were partially offset by higher than plan operation and maintenance expense due to well and pump house inspection costs.



SHAKOPEE PUBLIC UTILITIES

“Lighting the Way – Yesterday, Today and Beyond”

- Total Utility Operating Income was a loss of \$338k and was \$139k unfavorable to budget primarily due to lower than plan operating revenue that was partially offset by lower than plan operating expense.
- Total Utility Non-Operating Revenue was \$12k and was unfavorable to budget by \$6k due to lower than plan investment income and rental and miscellaneous income.
- Capital Contributions for the month of June were \$93k and were unfavorable to budget by \$56k due to lower than plan collection of trunk water and water connection fees in the month of June.
- Municipal contributions to the City of Shakopee totaled \$190k and were lower than plan by \$10k.
- Change in Net Position was a loss of \$0.4 million and was unfavorable to budget by \$0.2 million due to lower than plan operating revenues and lower than plan capital contributions which were partially offset by lower than plan operating expenses.
- Electric usage billed to customers in June was 32,399,655 KWH, an increase from May usage billed at 29,461,599 KWH.
- Water usage billed to customers in June was 150.3 million gallons, an increase from May usage billed at 89.7 million gallons.

Year to Date Financial Results – June, 2017

- Total Utility Operating Revenue year to date June was \$22.3 million and was slightly unfavorable to budget by \$115k or 0.5%. Electric revenues were slightly unfavorable to budget by \$32k or 0.2% driven by lower than plan power cost adjustment revenue due to lower than plan purchased power costs. Water revenues were unfavorable to budget by \$83k or 4.4% driven by lower than plan sales volumes in the residential and commercial revenue groups.
- Total Utility Operating Expenses year to date June were \$20.7 million and were favorable to budget by \$2.0 million or 9.2% primarily due to lower than plan purchased power costs of \$0.8 million, timing of expenditures in energy conservation of \$0.5 million, administrative and general expense of \$0.4 million in outside services and employee benefit expenses, electric and water operation and maintenance expense of \$0.1 million, and depreciation expense of \$0.2 million. Total Operating Expense for electric including purchased power was \$18.7 million and was favorable to budget by \$1.8 million or 8.9%. Total Operating Expense for Water was \$2.0 million and was also favorable to budget by \$0.3 million or 11.1%.
- Total Utility Operating Income was \$1.6 million and was favorable to budget by \$2.0 million driven by lower than plan operating expenses of \$2.1 million and offset by lower than planned operating revenues \$0.1 million.
- Total Utility Non-Operating Income was \$295k and was favorable to budget by \$44k due to higher than planned investment income of \$45k.
- YTD Capital Contributions were \$1.9 million and are favorable to budget by \$1.0 million due to higher than plan collection of water connection fees of \$0.9 million and higher than planned capital contributions of \$0.1 million.
- Municipal contributions to the City of Shakopee totaled \$1.1 million year to date and is lower than plan by \$62k or 5.2%. The actual estimated payment throughout the year is based on prior year results and will be trued up at the end of the year.
- YTD Change in Net Position is \$2.6 million and is favorable to budget by \$3.0 million reflecting lower than operating expense of \$2.0 million and higher than plan capital contributions of \$1.0 million.

SHAKOPEE PUBLIC UTILITIES
MONTH TO DATE FINANCIAL RESULTS
JUNE 2017



SHAKOPEE PUBLIC UTILITIES
"Lighting the Way – Yesterday, Today and Beyond"

SHAKOPEE PUBLIC UTILITIES
COMBINED STATEMENT OF REVENUES, EXPENSES AND CHANGES IN FUND NET POSITION

	Month to Date Actual - June 2017			Month to Date Budget - June 2017			Electric		Water		Total Utility	
	Electric	Water	Total Utility	Electric	Water	Total Utility	MTD Actual v. Budget B/(W)	%	MTD Actual v. Budget B/(W)	%	MTD Actual v. Budget B/(W)	%
	\$						\$		\$		\$	
OPERATING REVENUES	3,525,377	466,733	3,992,110	3,925,404	508,109	4,433,513	(400,027)	-10.2%	(41,376)	-8.1%	(441,404)	-10.0%
OPERATING EXPENSES												
Operation, Customer and Administrative	3,807,178	237,748	4,044,926	4,066,922	252,376	4,319,298	259,744	6.4%	14,627	5.8%	274,371	6.4%
Depreciation	173,238	112,404	285,642	189,194	124,473	313,667	15,956	8.4%	12,069	9.7%	28,025	8.9%
Amortization of Plant Acquisition	-	-	-	-	-	-	-	0.0%	-	-	-	0.0%
Total Operating Expenses	3,980,416	350,152	4,330,568	4,256,116	376,848	4,632,964	275,700	6.5%	26,696	7.1%	302,396	6.5%
Operating Income	(455,039)	116,580	(338,459)	(330,711)	131,260	(199,451)	(124,328)	-37.6%	(14,680)	-11.2%	(139,008)	-69.7%
NON-OPERATING REVENUE (EXPENSE)												
Rental and Miscellaneous	21,413	1,118	22,531	22,173	2,068	24,241	(760)	-3.4%	(950)	-45.9%	(1,710)	-7.1%
Interdepartment Rent from Water	7,500	-	7,500	7,500	-	7,500	-	0.0%	-	-	-	0.0%
Investment Income	8,141	3,804	11,945	12,951	3,002	15,954	(4,810)	-37.1%	802	26.7%	(4,008)	-25.1%
Interest Expense	(28,838)	(23)	(28,862)	(28,769)	(19)	(28,788)	(69)	-0.2%	(4)	-22.3%	(74)	-0.3%
Amortization of Debt Issuance Costs and Loss on Refunding	(1,484)	-	(1,484)	(1,484)	-	(1,484)	-	0.0%	-	-	-	0.0%
Gain/(Loss) on the Disposition of Property	-	-	-	-	-	-	-	-	-	-	-	0.0%
Total Non-Operating Revenue (Expense)	6,732	4,899	11,631	12,372	5,051	17,423	(5,640)	-45.6%	(152)	-3.0%	(5,792)	-33.2%
Income Before Contributions and Transfers	(448,307)	121,479	(326,828)	(318,339)	136,311	(182,028)	(129,968)	-40.8%	(14,832)	-10.9%	(144,800)	79.5%
CAPITAL CONTRIBUTIONS	-	93,404	93,404	-	149,395	149,395	-	-	(55,991)	-37.5%	(55,991)	-37.5%
MUNICIPAL CONTRIBUTION	(116,223)	(74,000)	(190,223)	(121,398)	(79,192)	(200,590)	5,175	4.3%	5,192	6.6%	10,368	5.2%
CHANGE IN NET POSITION	<u>\$ (564,530)</u>	<u>140,883</u>	<u>(423,646)</u>	<u>(439,737)</u>	<u>206,514</u>	<u>(233,223)</u>	<u>(124,793)</u>	<u>-28.4%</u>	<u>(65,631)</u>	<u>-31.8%</u>	<u>(190,423)</u>	<u>-81.6%</u>

SHAKOPEE PUBLIC UTILITIES

ELECTRIC OPERATING REVENUE AND EXPENSE

	MTD Actual June 2017	MTD Budget June 2017	MTD Actual v. Budget Better/(Worse)	
			\$	%
OPERATING REVENUES				
Sales of Electricity				
Residential	\$ 1,165,053	1,283,942	(118,889)	-9.3%
Commercial and Industrial	2,281,383	2,548,443	(267,061)	-10.5%
Uncollectible accounts	-	-	-	-
Total Sales of Electricity	3,446,436	3,832,385	(385,949)	-10.1%
Forfeited Discounts	13,452	21,016	(7,564)	-36.0%
Free service to the City of Shakopee	14,223	14,223	0	0.0%
Conservation program	51,266	57,780	(6,515)	-11.3%
Total Operating Revenues	3,525,377	3,925,404	(400,027)	-10.2%
OPERATING EXPENSES				
Operations and Maintenance				
Purchased power	3,425,764	3,521,339	95,575	2.7%
Distribution operation expenses	31,652	39,436	7,784	19.7%
Distribution system maintenance	48,828	55,428	6,601	11.9%
Maintenance of general plant	15,576	35,652	20,076	56.3%
Total Operation and Maintenance	3,521,819	3,651,855	130,036	3.6%
Customer Accounts				
Meter Reading	8,512	9,810	1,298	13.2%
Customer records and collection	53,030	44,751	(8,279)	-18.5%
Energy conservation	29,160	58,828	29,668	50.4%
Total Customer Accounts	90,702	113,389	22,687	20.0%
Administrative and General				
Administrative and general salaries	50,626	49,969	(656)	-1.3%
Office supplies and expense	4,622	15,471	10,849	70.1%
Outside services employed	3,750	40,959	37,209	90.8%
Insurance	8,938	15,727	6,789	43.2%
Employee Benefits	113,804	143,488	29,684	20.7%
Miscellaneous general	12,917	36,063	23,146	64.2%
Total Administrative and General	194,657	301,678	107,021	35.5%
Total Operation, Customer, & Admin Expenses	3,807,178	4,066,922	259,744	6.4%
Depreciation	173,238	189,194	15,956	8.4%
Amortization of plant acquisition	-	-	-	0.0%
Total Operating Expenses	\$ 3,980,416	4,256,116	275,700	6.5%
OPERATING INCOME	\$ (455,039)	(330,711)	(124,328)	-37.6%

SHAKOPEE PUBLIC UTILITIES

WATER OPERATING REVENUE AND EXPENSE

	MTD Actual June 2017	MTD Budget June 2017	MTD Actual v. Budget Better/(Worse)	
			\$	%
OPERATING REVENUES				
Sales of Water	\$ 465,583	506,378	(40,794)	-8.1%
Forfeited Discounts	1,149	1,731	(582)	-33.6%
Uncollectible accounts	-	-	-	-
Total Operating Revenues	466,733	508,109	(41,376)	-8.1%
OPERATING EXPENSES				
Operations and Maintenance				
Pumping and distribution operation	35,276	39,294	4,019	10.2%
Pumping and distribution maintenance	68,000	33,731	(34,269)	-101.6%
Power for pumping	23,734	23,252	(481)	-2.1%
Maintenance of general plant	222	2,342	2,120	90.5%
Total Operation and Maintenance	127,232	98,620	(28,611)	-29.0%
Customer Accounts				
Meter Reading	4,431	7,592	3,160	41.6%
Customer records and collection	14,400	11,996	(2,403)	-20.0%
Energy conservation	1,004	2,000	996	-
Total Customer Accounts	19,835	21,588	1,753	8.1%
Administrative and General				
Administrative and general salaries	31,108	31,460	352	1.1%
Office supplies and expense	1,814	5,926	4,113	69.4%
Outside services employed	1,642	17,377	15,735	90.5%
Insurance	2,979	5,242	2,263	43.2%
Employee Benefits	42,295	52,190	9,896	19.0%
Miscellaneous general	10,844	19,971	9,127	45.7%
Total Administrative and General	90,682	132,167	41,486	31.4%
Total Operation, Customer, & Admin Expenses	237,748	252,376	14,627	5.8%
Depreciation	112,404	124,473	12,069	9.7%
Amortization of plant acquisition	-	-	-	-
Total Operating Expenses	350,152	376,848	26,696	7.1%
OPERATING INCOME	\$ 116,580	131,260	(14,680)	-11.2%

SHAKOPEE PUBLIC UTILITIES
YEAR TO DATE FINANCIAL RESULTS
JUNE 2017



SHAKOPEE PUBLIC UTILITIES

"Lighting the Way – Yesterday, Today and Beyond"

SHAKOPEE PUBLIC UTILITIES
COMBINED STATEMENT OF REVENUES, EXPENSES AND CHANGES IN FUND NET POSITION

	Year to Date Actual - June 2017			Year to Date Budget - June 2017			Electric		Water		Total Utility	
	Electric	Water	Total Utility	Electric	Water	Total Utility	YTD Actual v. Budget B/(W) \$ %		YTD Actual v. Budget B/(W) \$ %		YTD Actual v. Budget B/(W) \$ %	
OPERATING REVENUES	\$ 20,508,935	1,795,535	22,304,470	20,540,976	1,878,549	22,419,525	(32,041)	-0.2%	(83,014)	-4.4%	(115,055)	-0.5%
OPERATING EXPENSES												
Operation, Customer and Administrative	17,626,004	1,366,845	18,992,849	19,364,968	1,548,253	20,913,221	1,738,964	9.0%	181,408	11.7%	1,920,372	9.2%
Depreciation	1,039,426	674,426	1,713,852	1,135,163	746,837	1,882,000	95,737	8.4%	72,412	9.7%	168,148	8.9%
Amortization of Plant Acquisition	-	-	-	-	-	-	-	0.0%	-	-	-	0.0%
Total Operating Expenses	18,665,430	2,041,271	20,706,701	20,500,131	2,295,090	22,795,221	1,834,701	8.9%	253,820	11.1%	2,088,520	9.2%
 Operating Income	 1,843,505	 (245,736)	 1,597,769	 40,845	 (416,542)	 (375,697)	 1,802,660	 4413.4%	 170,806	 41.0%	 1,973,466	 525.3%
NON-OPERATING REVENUE (EXPENSE)												
Rental and Miscellaneous	121,127	168,727	289,853	133,039	160,977	294,016	(11,912)	-9.0%	7,750	4.8%	(4,163)	-1.4%
Interdepartment Rent from Water	45,000	-	45,000	45,000	-	45,000	-	0.0%	-	-	-	0.0%
Investment Income	108,420	32,801	141,221	77,708	18,013	95,721	30,712	39.5%	14,788	82.1%	45,499	47.5%
Interest Expense	(174,658)	(139)	(174,797)	(174,119)	(114)	(174,233)	(539)	-0.3%	(24)	-21.3%	(564)	-0.3%
Amortization of Debt Issuance Costs and Loss on Refunding	(8,901)	-	(8,901)	(8,901)	-	(8,901)	-	0.0%	-	0.0%	-	0.0%
Gain/(Loss) on the Disposition of Property	(306)	3,362	3,056	-	-	-	(306)	0.0%	3,362	-	3,056	-
Total Non-Operating Revenue (Expense)	90,681	204,750	295,432	72,727	178,875	251,603	17,954	24.7%	25,875	14.5%	43,829	17.4%
 Income Before Contributions and Transfers	 1,934,186	 (40,986)	 1,893,201	 113,572	 (237,667)	 (124,094)	 1,820,614	 1603.0%	 196,681	 82.8%	 2,017,295	 1625.6%
CAPITAL CONTRIBUTIONS	94,254	1,771,648	1,865,902	-	896,371	896,371	94,254	-	875,277	97.6%	989,530	108.2%
MUNICIPAL CONTRIBUTION	(696,628)	(444,503)	(1,141,131)	(728,388)	(475,154)	(1,203,542)	31,760	4.4%	30,652	6.5%	62,412	5.2%
 CHANGE IN NET POSITION	 \$ 1,331,812	 1,286,159	 2,617,971	 (614,816)	 183,550	 (431,265)	 1,946,627	 316.6%	 1,102,609	 600.7%	 3,049,237	 707.0%

SHAKOPEE PUBLIC UTILITIES
ELECTRIC OPERATING REVENUE AND EXPENSE

	YTD Actual June 2017	YTD Budget June 2017	YTD Actual v. Budget Better/(Worse)	
			\$	%
OPERATING REVENUES				
Sales of Electricity				
Residential	\$ 7,042,383	7,128,367	(85,984)	-1.2%
Commercial and Industrial	12,957,605	12,889,702	67,903	0.5%
Uncollectible accounts	-	-	-	-
Total Sales of Electricity	19,999,987	20,018,068	(18,081)	-0.1%
Forfeited Discounts	125,635	126,096	(461)	-0.4%
Free service to the City of Shakopee	85,337	85,336	0	0.0%
Conservation program	297,976	311,475	(13,499)	-4.3%
Total Operating Revenues	20,508,935	20,540,976	(32,041)	-0.2%
OPERATING EXPENSES				
Operations and Maintenance				
Purchased power	15,206,787	15,989,470	782,683	4.9%
Distribution operation expenses	209,816	236,616	26,800	11.3%
Distribution system maintenance	378,291	332,569	(45,722)	-13.7%
Maintenance of general plant	117,339	213,911	96,572	45.1%
Total Operation and Maintenance	15,912,232	16,772,566	860,333	5.1%
Customer Accounts				
Meter Reading	50,736	58,858	8,122	13.8%
Customer records and collection	268,477	268,508	31	0.0%
Energy conservation	(195,103)	352,969	548,071	155.3%
Total Customer Accounts	124,110	680,335	556,225	81.8%
Administrative and General				
Administrative and general salaries	283,043	299,816	16,773	5.6%
Office supplies and expense	75,173	92,825	17,652	19.0%
Outside services employed	71,526	245,757	174,230	70.9%
Insurance	94,651	94,362	(289)	-0.3%
Employee Benefits	865,127	962,931	97,804	10.2%
Miscellaneous general	200,141	216,376	16,236	7.5%
Total Administrative and General	1,589,662	1,912,068	322,406	16.9%
Total Operation, Customer, & Admin Expenses	17,626,004	19,364,968	1,738,964	9.0%
Depreciation	1,039,426	1,135,163	95,737	8.4%
Amortization of plant acquisition	-	-	-	0.0%
Total Operating Expenses	\$ 18,665,430	20,500,131	1,834,701	8.9%
OPERATING INCOME	\$ 1,843,505	40,845	1,802,660	4413.4%

SHAKOPEE PUBLIC UTILITIES

WATER OPERATING REVENUE AND EXPENSE

	YTD Actual June 2017	YTD Budget June 2017	YTD Actual v. Budget Better/(Worse)	
			\$	%
OPERATING REVENUES				
Sales of Water	\$ 1,789,380	1,868,161	(78,781)	-4.2%
Forfeited Discounts	6,155	10,388	(4,233)	-40.7%
Uncollectible accounts	(0)	-	(0)	-
Total Operating Revenues	1,795,535	1,878,549	(83,014)	-4.4%
OPERATING EXPENSES				
Operations and Maintenance				
Pumping and distribution operation	240,866	235,766	(5,100)	-2.2%
Pumping and distribution maintenance	174,501	202,387	27,886	13.8%
Power for pumping	140,813	139,515	(1,299)	-0.9%
Maintenance of general plant	20,226	14,054	(6,172)	-43.9%
Total Operation and Maintenance	576,406	591,721	15,315	2.6%
Customer Accounts				
Meter Reading	27,607	45,551	17,944	39.4%
Customer records and collection	72,477	71,978	(499)	-0.7%
Energy conservation	1,735	12,000	10,265	-
Total Customer Accounts	101,819	129,529	27,710	21.4%
Administrative and General				
Administrative and general salaries	182,271	188,762	6,491	3.4%
Office supplies and expense	33,681	35,558	1,876	5.3%
Outside services employed	24,594	104,261	79,668	76.4%
Insurance	31,550	31,454	(96)	-0.3%
Employee Benefits	307,861	347,142	39,281	11.3%
Miscellaneous general	108,662	119,826	11,163	9.3%
Total Administrative and General	688,620	827,003	138,383	16.7%
Total Operation, Customer, & Admin Expenses	1,366,845	1,548,253	181,408	11.7%
Depreciation	674,426	746,837	72,412	9.7%
Amortization of plant acquisition	-	-	-	-
Total Operating Expenses	\$ 2,041,271	2,295,090	253,820	11.1%
OPERATING INCOME	\$ (245,736)	(416,542)	170,806	41.0%